

# Anigen Rapid CPV/CCV/Giardia Ag

## Why test CPV/CCV/Giardia together?

- **Differential diagnosis**

- Determine treatment options by differential diagnosis of three important pathogens of enteritis with similar clinical symptoms

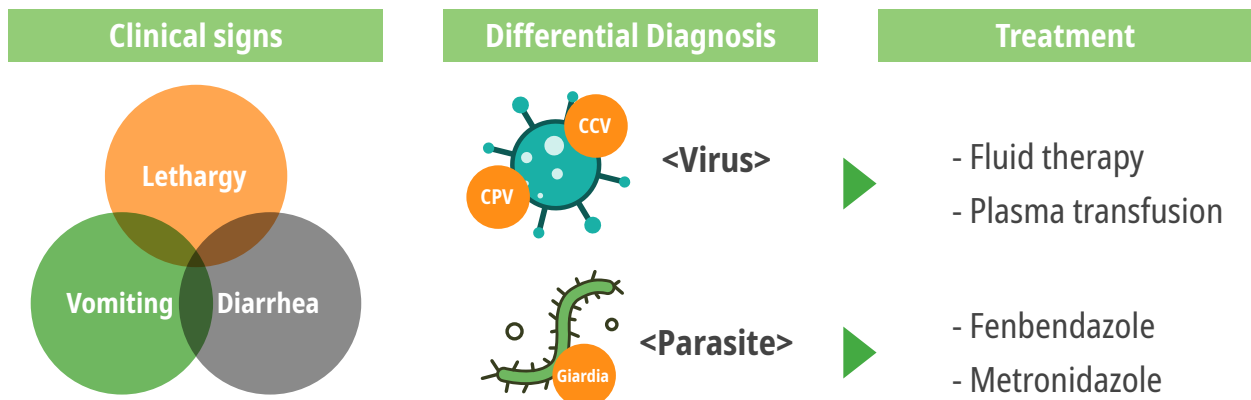

- **Concurrent infection**

- Check if there is a concurrent infection to determine the intensity of treatment

Frequently occur	More severe symptoms
<ul style="list-style-type: none"><li>- Pathogen makes the intestine more susceptible to additional infection</li></ul>	<ul style="list-style-type: none"><li>- Bad prognosis</li><li>- Requires more aggressive care of disease</li></ul>

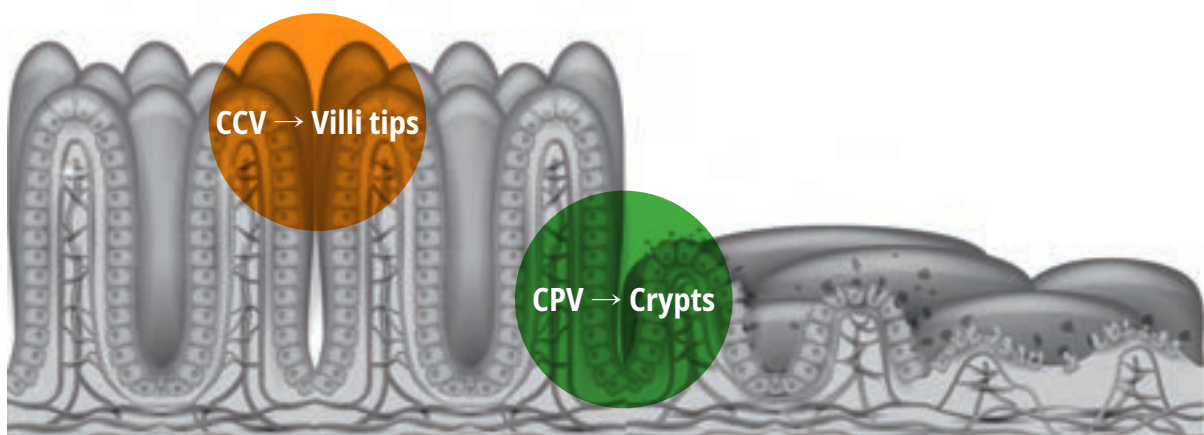

## • Specifications

- » Species : Dog
- » Sample : Feces
- » Testing time : 5~10 minutes
- » Special Features
  - Simultaneous detection of CPV, CCV and Giardia
  - One-step testing procedure
  - Accurate results



CPV	<ul style="list-style-type: none"> <li>- Detection of pathogenic CPV subtypes (CPV2,2a,2b,2c)</li> <li>- Sensitivity 100%, Specificity 98.8%</li> </ul>
CCV	<ul style="list-style-type: none"> <li>- World's first CCV Ag rapid test</li> <li>- Sensitivity 93.1%, Specificity 97.5%</li> </ul>
Giardia	<ul style="list-style-type: none"> <li>- No cross-reaction with other intestinal parasites</li> <li>- Detection limit : 125/100 µl</li> </ul>

## • Test Procedure

[ Proper sample amount collected by a swab ]

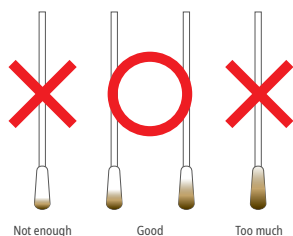

1 Collect a sample from the canine feces by using the swab

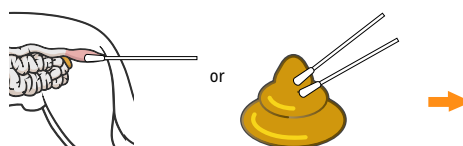

2 Insert the swab into the sample collection tube and stir the swab at least 10 times

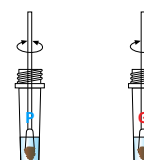

3 Discard the swab while squeezing the swab against the wall of the tube

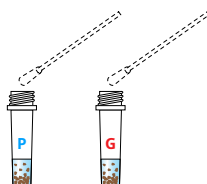

4 Wait until large particles to sink and take the supernatant by using the disposable dropper provided

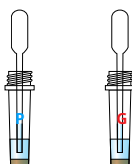

5 Add 4 drops into the sample hole on the test device

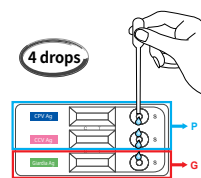

### Interpretation

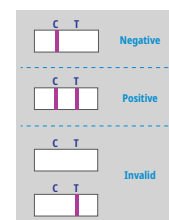

## • Ordering Information

Product No.	Product Name	Product Type	Packing Unit
RC112DC	Rapid CPV/CCV/Giardia Ag	Device	5 Tests/Kit

